



QMAKS
BUILDERS & DEVELOPERS
BUILD UP YOUR FUTURE
— ESTABLISHED IN 2013 —

**BANK LOAN
APPROVED**



—  —
where elegance meets excellence

About Us

Qmaks Builders & Developers have been sparking since 2013, driven by a dedication to creating affordable and comfortable homes, embodying the essence of a satisfying life. Over nearly two decades, our unwavering commitment has shaped Hyderabad's landscape with contemporary residential and commercial wonders.

Our unwavering mission centers on creating environments that harmoniously fuse comfort and serenity. Through vast green spaces and a range of invigorating amenities, we construct a haven for endless joy. Continuously evolving, we adopt innovative, practical, and sustainable ideas to fulfill fundamental needs. Our interpretation of luxury intertwines cleverly crafted living spaces with essential amenities, culminating in an unmatched living experience where distinctive architecture seamlessly blends.

Our structures seamlessly combine elegance and practicality, offering cost-effective apartments adorned with expansive windows to enhance ventilation and the feeling of openness. we reveal numerous opportunities for potential homeowners, presenting top-notch properties in Hyderabad accompanied by premium amenities.

OUR ON-GOING PROJECTS



OUR COMPLETED PROJECTS



PLATINA

BY QMAKS

QMAKS PLATINA caters to individuals with expansive dreams. Nestled in DOLLOR HILLS, a sought-after area in Hyderabad, these homes stand out due to their prime location, impressive elevation, and sturdy construction. This prestigious project is tailored for a select few seeking the finest living space in one of Hyderabad's most coveted neighborhoods.

QMAKS PLATINA presents a fusion of commercial and residential spaces, offering 3-bedroom apartments designed with elegance. It boasts refined interiors, generous rooms, basement parking, a well-thought-out floor plan, and various other amenities. Each floor comprises six units without shared walls, meticulously integrated for optimal living comfort.

QMAKS PLATINA invites you to fully equipped homes tailored for a world-class lifestyle. From the sophisticated teakwood doorway to the roomy interiors, vitrified tiles, and state-of-the-art fittings, this residence offers every amenity you could desire in a meticulously designed home.

BRANDED LIFTS | PREMIER FITTINGS | UNCOMPROMISED QUALITY | WELL-ENVISIONED FLOOR PLAN

SPECIFICATIONS



STRUCTURE

R.C.C. framed structure as per Structure Drawing designed by Qualified & Reputed Structural Engineer with Stability Certificate.



SUPER STRUCTURE

Best Quality AAC Block Light Weight.



PLASTERING

External & internal plastering in cement mortar in two coats with sponge finishing



PAINTING

Lupsum finish-Asian tractor emulsion for interiors, Ace/Apex for exteriors. Elevation and balconies in Birla putty or equivalent



DOORS

All Doors Standard Quality
Main door in teakwood,
Internal doors: Molded flush
All frames teakwood 4/3" section.



FLOORING

Vitrified tiles of Anti skid double charge in living area, drawing, dining & bedrooms. Ceramic tiles in toilets



BACKUP

Back-up facility for lift, common area & car parking.



WATER SUPPLY

HMWSSB tap water connection along with sump and water pumping facility for distribution of bore-well.



FALSE CEILING

False Ceiling in hall, dining, & bedrooms



2 LIFTS

Two lifts of 6 persons capacity. Standard Lift Granite ducting on walls



KITCHEN

Granite top platform, fully moulded with stainless steels sink, glazed tiles dadoing upto 2.5 feet height above the platform.



ELECTRICALS

Copper wiring and modular switches. Make- ISI Co. AC outlet points in all bedrooms & Living area 3 phase meters for each flat. Electricity transformer 160KV



TOILETS

European Wcs in all toilets of Hindware Parryware or Cera or equivalent with fittings and tiles upto door level.



Compound wall and gate

Stainless Steel Railing for staircase and balconies

TYPICAL FLOOR PLAN



AREA STATEMENT IN SFT

Flat no - 1	1475.00	Flat no - 4	1300.00
Flat no - 2	1520.00	Flat no - 5	1375.00
Flat no - 3	1300.00	Flat no - 6	1250.00

NOTE

Car parking and amenities with extra cost

Persons desiring to alter /modify their flat shall inform the same at the time of booking & sign the request for modification form

Registration, GST applicable As per Govt. Norms.

**PREMIUM 3 BHK
RESIDENCES**



FLAT NO 1 | 1475 SFT



FLAT NO 2 | 1520 SFT



FLAT NO 3 | 1300 SFT



FLAT NO 4 | 1300 SFT



FLAT NO 5 | 1375 SFT



FLAT NO 6 | 1250 SFT



STILT & FIRST FLOOR PLAN

STILT FLOOR PLAN

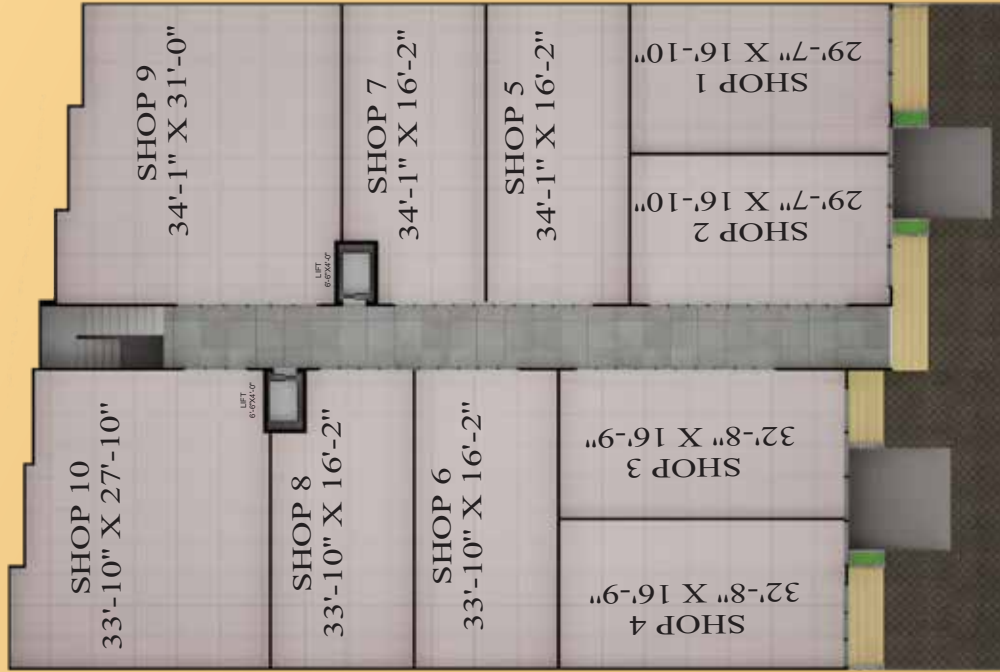

FIRST FLOOR PLAN

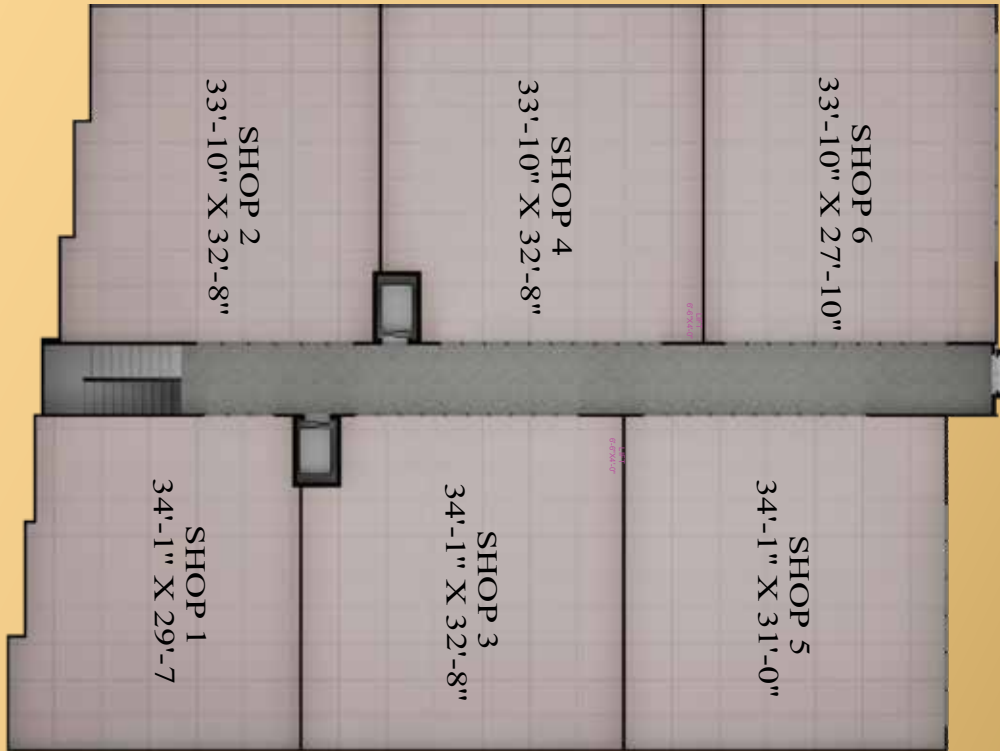

100 FEET WIDE ROAD

STILT FLOOR PLAN

Shops	Sqft	Shops	Sqft
Shop no - 1	740.00	Shop no - 7	740.00
Shop no - 2	740.00	Shop no - 8	725.00
Shop no - 3	775.00	Shop no - 9	1425.00
Shop no - 4	775.00	Shop no - 10	1275.00
Shop no - 5	740.00		
Shop no - 6	725.00		

FIRST FLOOR PLAN

Shops	Sqft
Shop no - 1	1475.00
Shop no - 2	1550.00
Shop no - 3	1475.00
Shop no - 4	1450.00
Shop no - 5	1425.00
Shop no - 6	1275.00

CELLAR FLOOR PLAN
PARKING

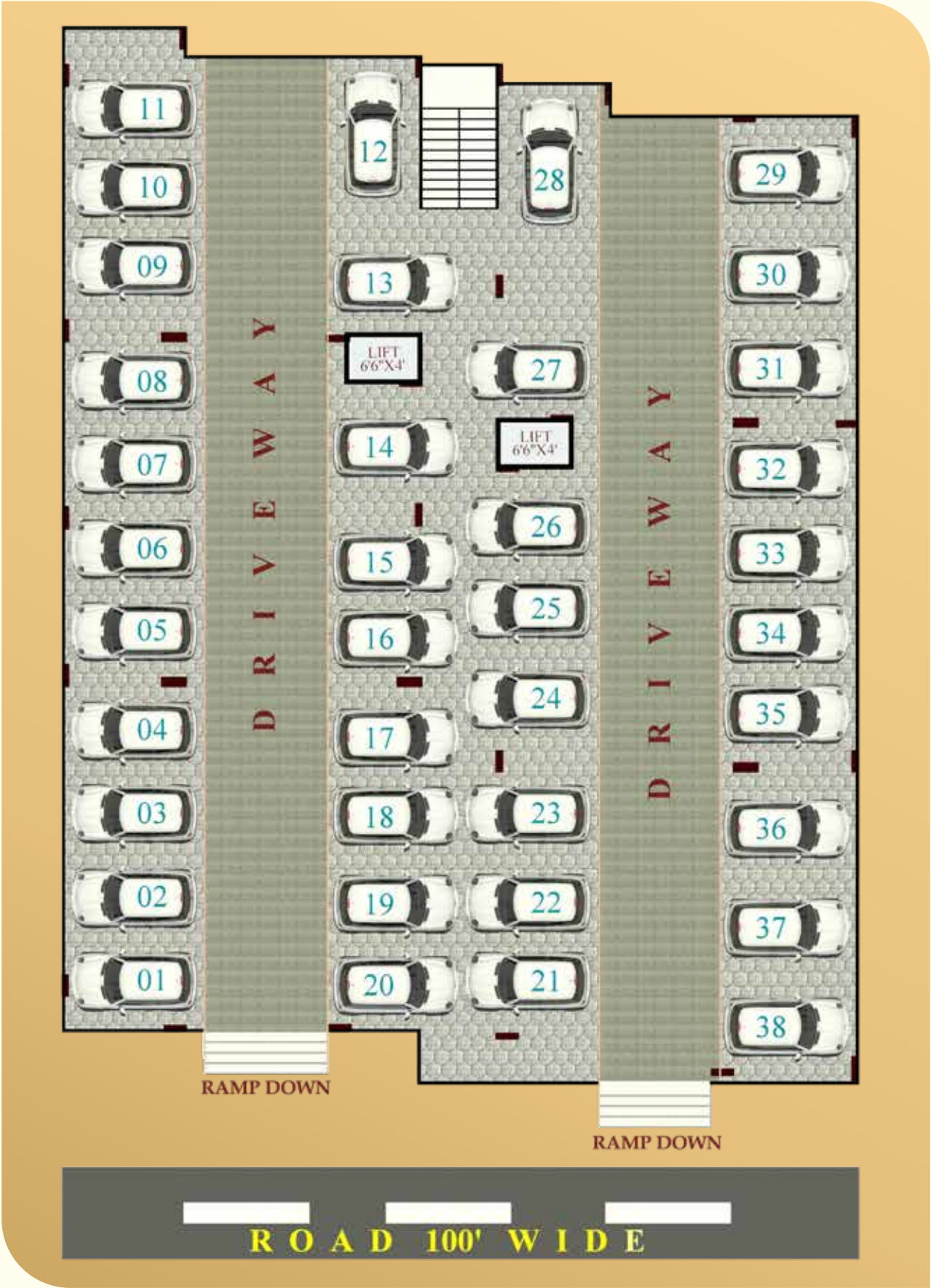

AN ENIGMATIC FUSION OF OLD WORLD CHARM & URBAN DEVELOPMENT



EDUCATION

QUEEN INTERNATIONAL SCHOOL
SCHOLARS INTERNATIONAL SCHOOL
AZRA INTERNATIONAL SCHOOL
ELATE INTERNATIONAL SCHOOL
CAPTAIN INTERNATIONAL SCHOOL

HOSPITALS

AARON HOSPITAL
UNEEDS HOSPITAL
AVASA HOSPITAL
DELIGHT HOSPITAL
PRERANA HOSPITAL

ENTERTAINMENT

PVR PRESTON PRIME
AMB CINEMAS
MALKAM CHERUVU
GOLCONDA FORT
QUTUB SHAHI TOMBS

IT/CORPORATES

WAVEROCK SEZ -9.5 KMS
CAPGEMINI -8.7 KMS
ACCENTURE -8 KMS
BROADCOM -9 KMS
WIPRO -10 KMS

Q M A K S

BUILDERS & DEVELOPERS

Plot No. 87, 88, SA Colony, Tolichowki, Hyd.

Website: www.qmaks.com | E-mail: sales@qmaks.com

TOLL FREE NO. : 1800 1200 786

Scan QR Code
For
Further Details:



NOTE: This brochure is only a conceptual presentation of the project and not a legal offering the promoters reserves right to make changes in plans, specifications and elevation as deemed fit.

